



BRYAN COLLINS, FIRE CHIEF

2120 N. Wilbur
Spokane Valley, WA 99206
(509) 928-1700 Main
(509) 892-4125 Fax
spokanevalleyfire.com

PLAT DESIGN REQUIREMENTS

- If a hydrant is not located within 600 feet of furthest lot in plat a new hydrant will be required
- Water plans are required for new hydrants
- A fire apparatus turnaround is required when the furthest lot is 150 feet or more down a private drive/road
- Road names require approval and shall coincide with established names in the surrounding road grid
- A fire apparatus turnaround may be:
 - a) A cul-de-sac with a 100 foot diameter
 - b) A hammerhead - minimum of 200 feet wide with 30 foot turning radii

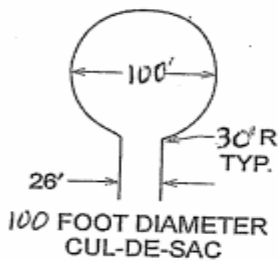

(a)

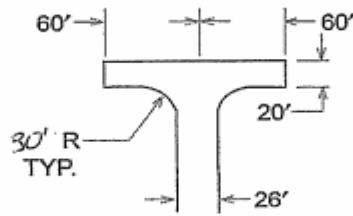

(b)

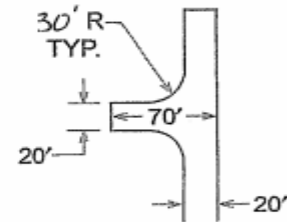

- Maximum grade for fire apparatus access is 10%
- Fire apparatus access road/drive shall be posted "No Parking – Fire Lane":
 - a) 20 feet by 26 feet – both sides
 - b) More than 26 feet and less than 32 feet – one side
 - c) 32 feet or more – not required

Sign Types

